

Drinking Water Faucets

Premium Designer Tapware

i The width (W) refers to the dimension from the centre line of the tap body to the centre of the spout.

Standard Filter Faucets

Included with your purchase of an Undersink Filter System. All our Standard Filter Faucets feature a chrome finish and include a base plate and connection fittings.



Long Reach IT001155

Spring Loaded



High Loop IT001161



IT001162

Mode



IT003638

Retro



Long Reach IT001156

Euro



High Loop IT001157



IT001692

Metro



IT001177

Petite



IT002948

Antique



IT001175

Fin



IT002961

Fin

with Filter Life Indicator*



IT001170

Dual

Ambient & Cool*

For more information go to www.watershop.com.au

*Not included as standard.

Drinking Water Faucets

Matte Black Filter Faucets



Short IT003623



Tall IT003622



IT003624

Petite

Mode

Mixers - Hot, Cold & Filtered Faucets

Our Mixers feature a bright chrome finish and are fitted with an included base plate.

Water Rating Label

The water rating label is displayed against products regulated under the Water Efficiency Labelling and Standards (WELS) scheme.

Our 3 Way, Nova, Side Lever, Stainless Steel Premier and Stainless Steel High Loop Mixers have been registered according to the requirements of the WELS standard (AS/NZS 6400:2016 water efficient products). For more information please visit www.watershop.com.au/mixers.

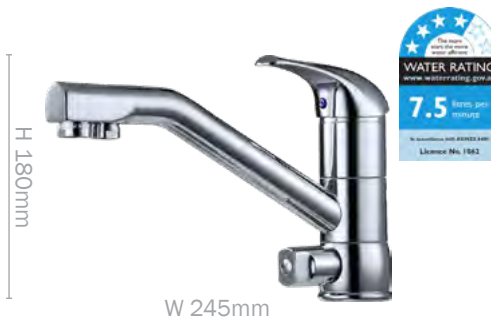

IT001165

3 Way



IT001980

Nova



IT002849

Flat



Standard IT001169

Side Lever



High Loop IT003855

Stainless Steel Filter Faucets

Our Stainless Steel Filtered Water Faucets and Mixers feature a brushed chrome finish.



Stainless Steel Mixers - Hot, Cold & Filtered Faucets

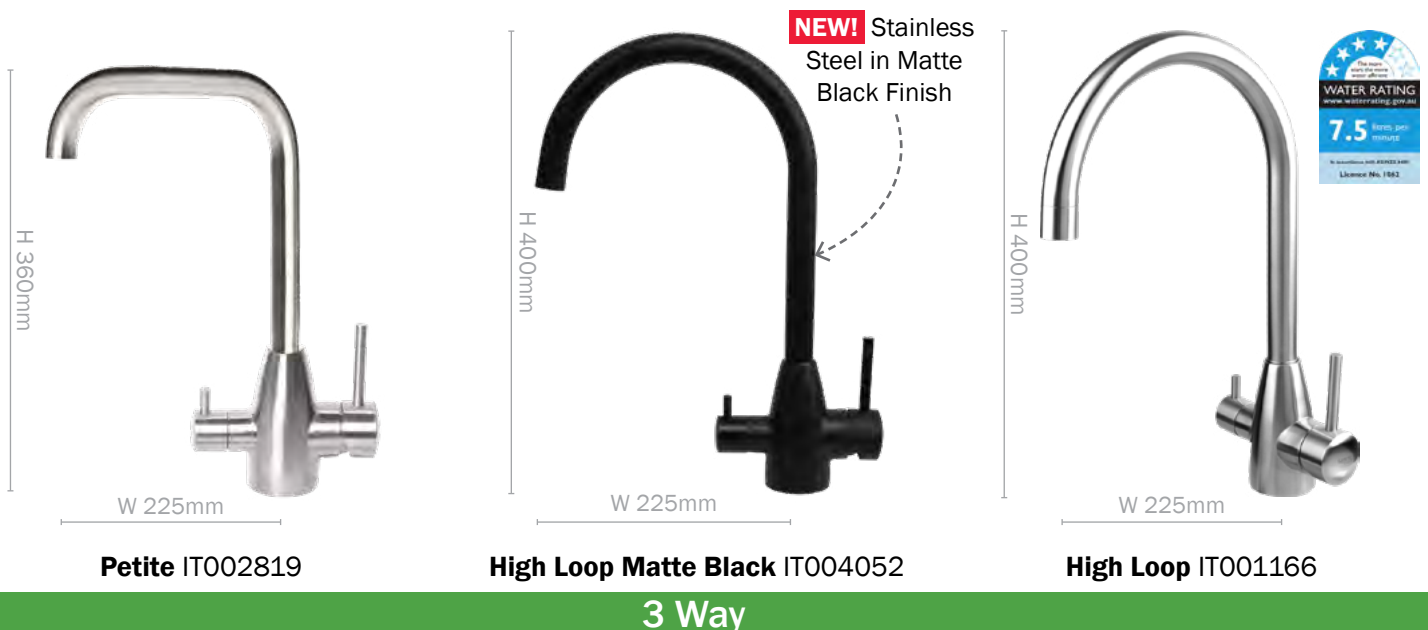

Your step by step guide to Installing Your Drinking Water Faucet

PLEASE READ THESE INSTRUCTIONS CAREFULLY BEFORE ATTEMPTING INSTALLATION

The pure water faucet may be installed on any flat surface over 50mm (2") in diameter. Remember to check the underside of the benchtop location for interference.

IMPORTANT: The following instructions are general in nature and may vary from tap to tap. These instructions are **not** for stone or granite benchtops.

Step by Step Instructions

1. Select a location for your new faucet: your faucet may be installed on any flat surface over 50mm (2") in diameter. It is recommended to make a small indent using a centre punch to mark the desired drilling location.
2. Drill a hole for the faucet - First drill a 3mm pilot hole. Then drill a 12mm final hole.
3. Assemble the faucet fittings according to your chosen faucet - refer to Diagram 1 or 2. Tighten firmly, ensuring that the faucet is correctly aligned in the desired direction over the sink basin.
4. Install female Quick Fit Connector to the end of the faucet and connect tube (refer to Diagram 3).

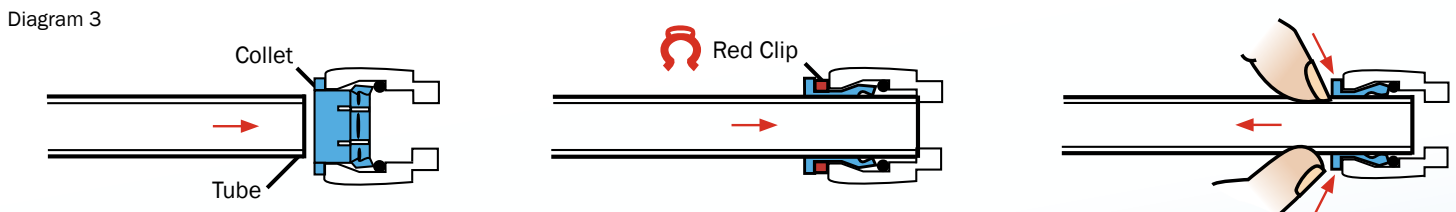
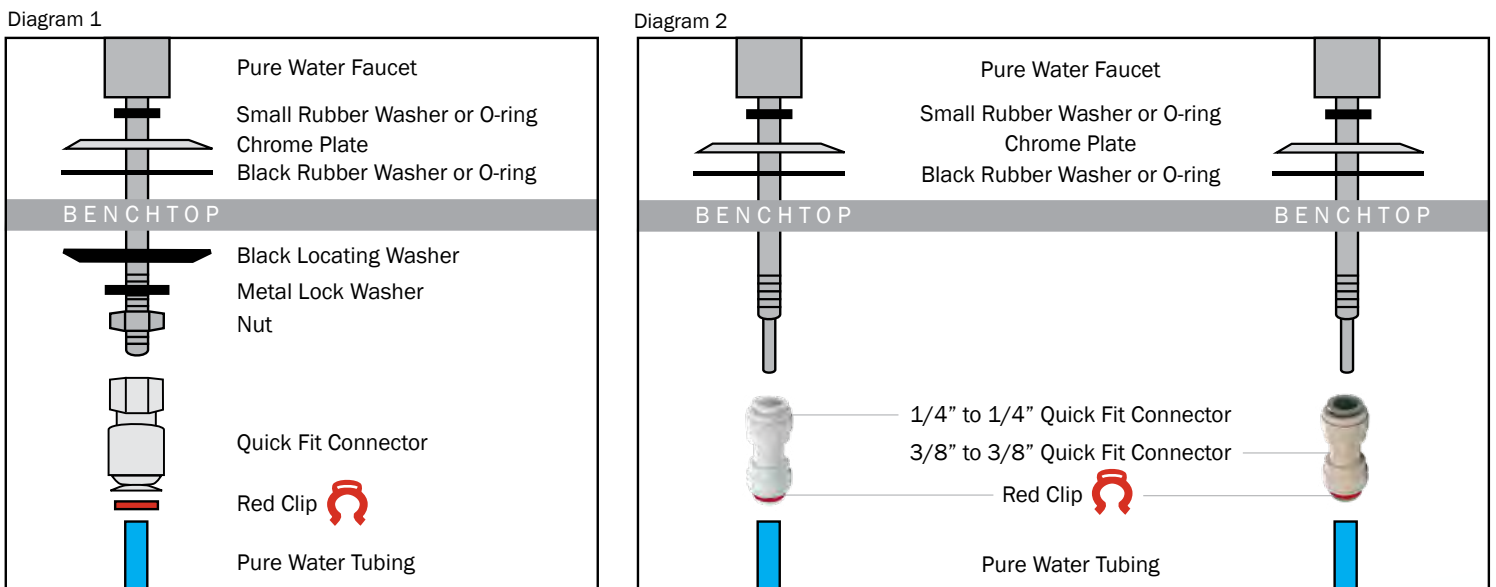

North Shore Showroom
425 Miller Street. Cammeray NSW 2062

Inner West Showroom
350 Parramatta Road, Stanmore NSW 2048

02 9458 1111 sales@watershop.com.au www.watershop.com.au